

Cefiso

design
Alessandro Pedretti

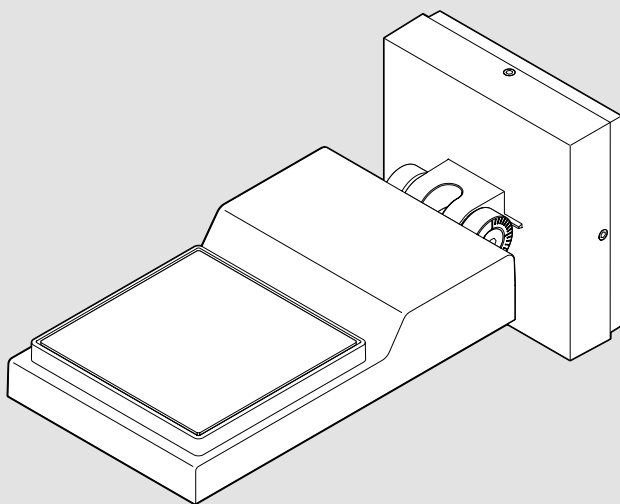

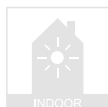

i

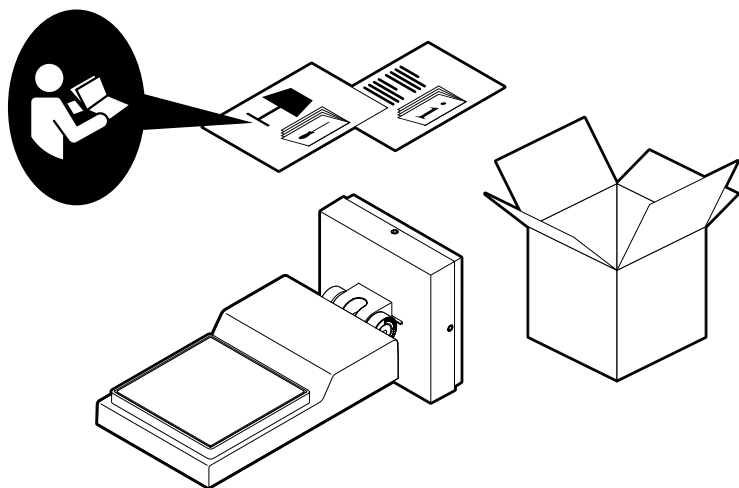
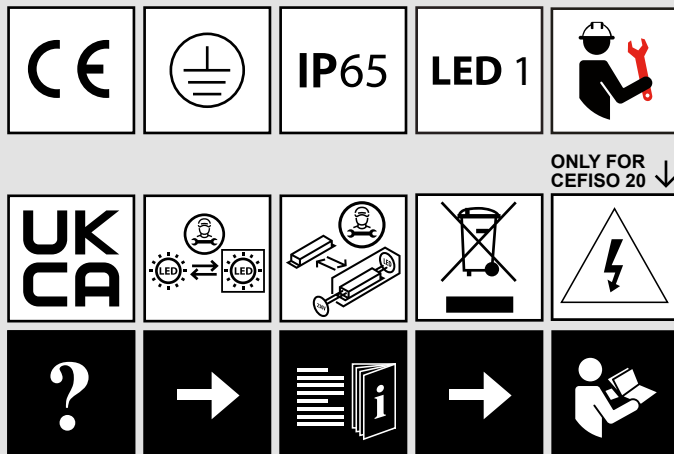

1

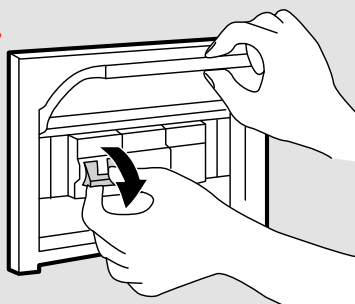
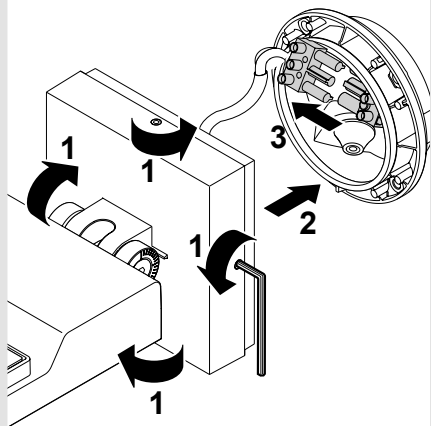

2

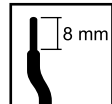
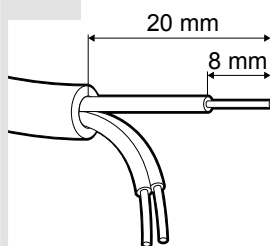

i

CEFISO 14

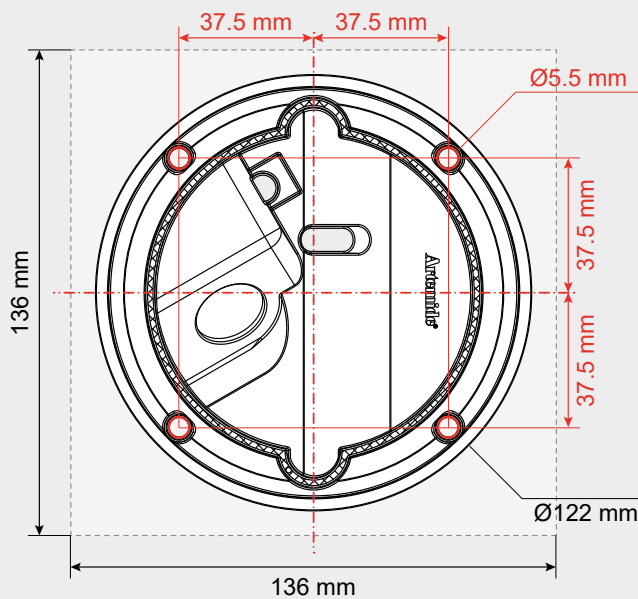

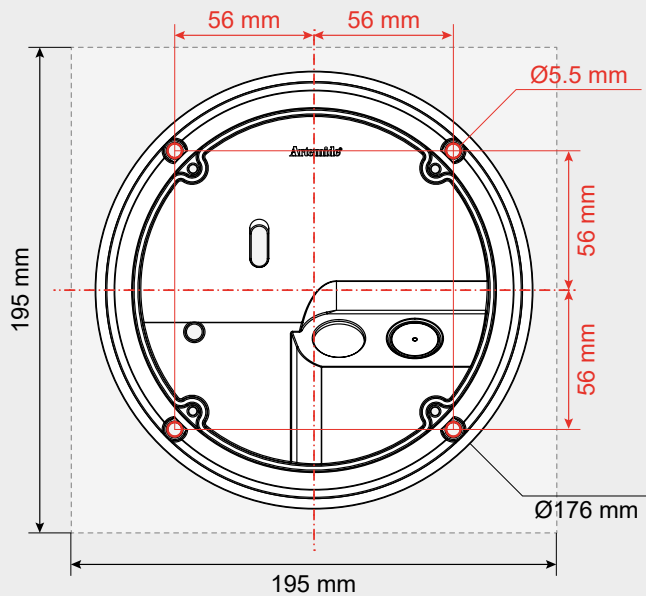
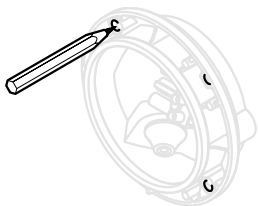
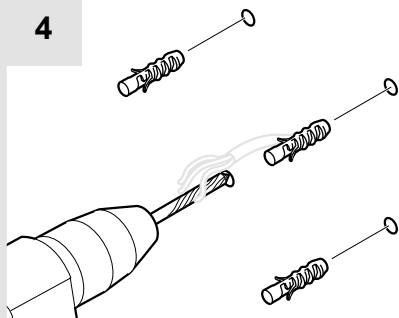
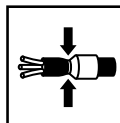
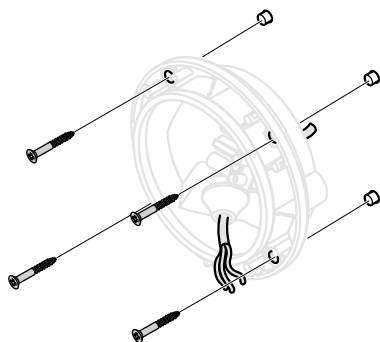
i**CEFISO 20****3****4****5**

6

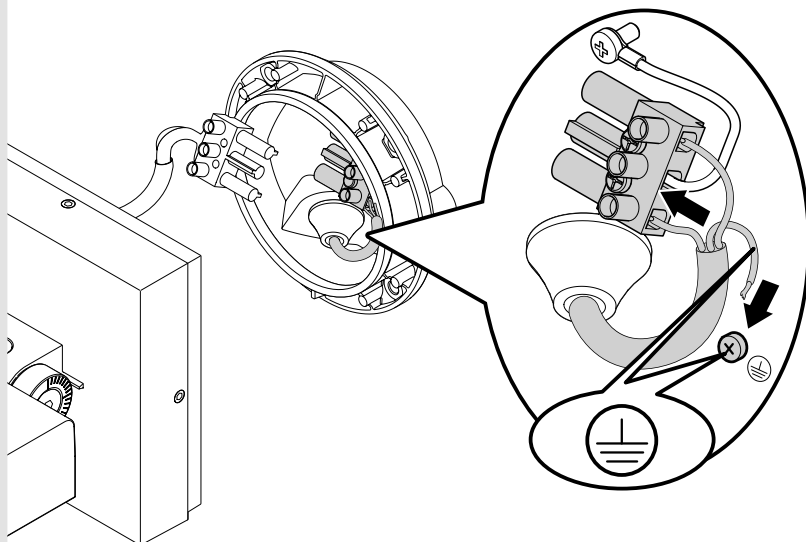

7

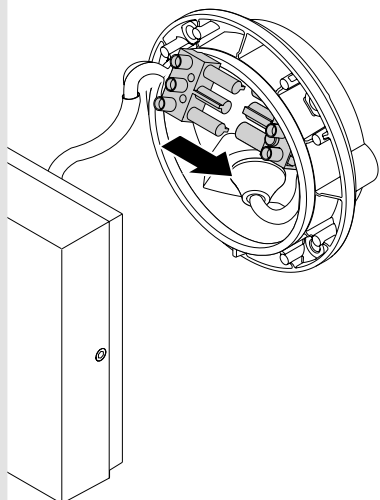

8

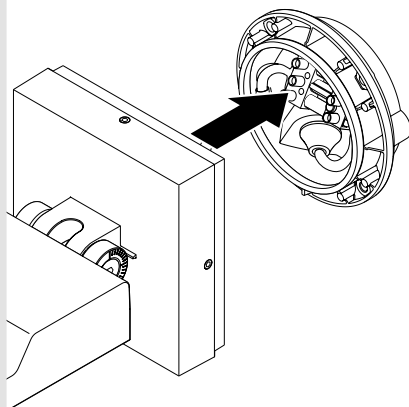

9

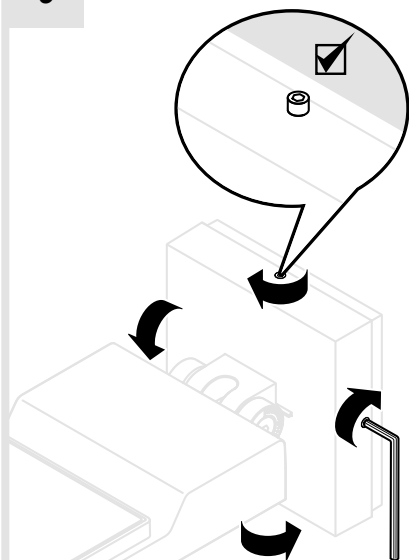

10

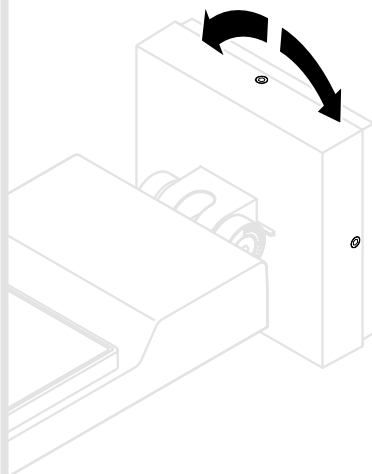

11

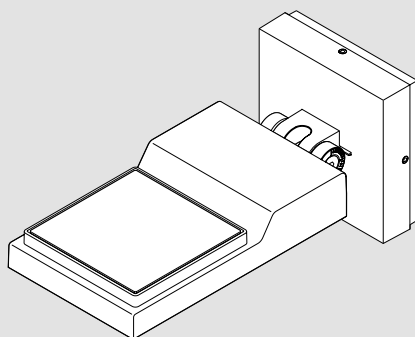
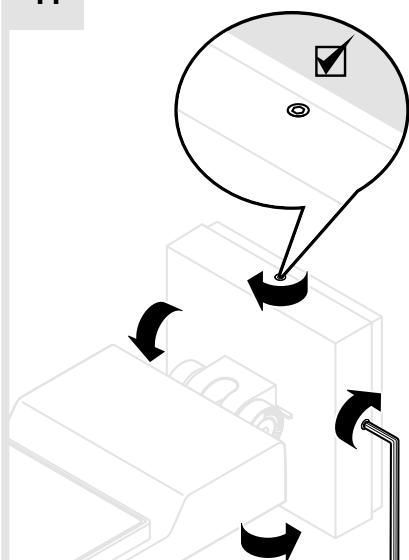

12

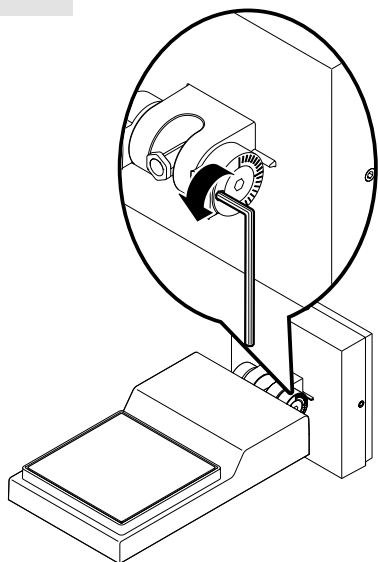

13

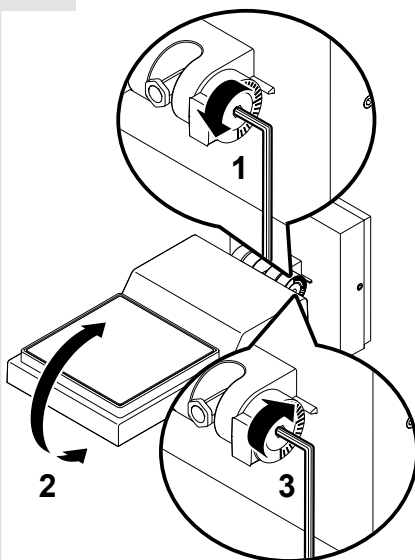

14

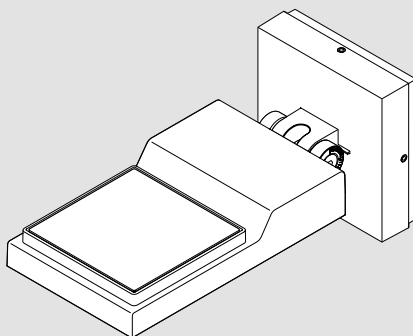
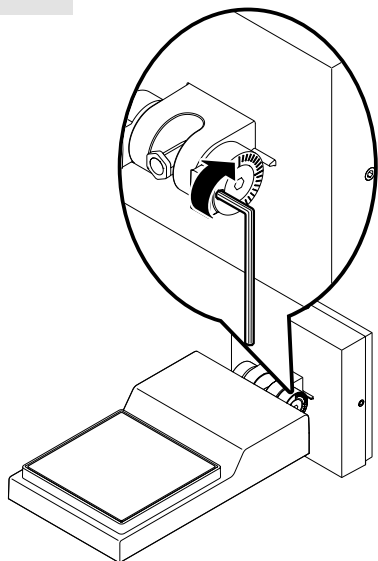

Artemide®

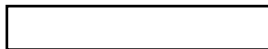

Artemide

via Bergamo, 18
20006 Pregnana M.se (MI)
ITALIA

tel. +39 02 935 181
fax +39 02 935 90 254
fax +39 02 935 90 496

www.artemide.com

VAT IT00846890150

cod. Y513000032G